

MATERIALS AND COLORS

STEPS

- Solid beech wood, 40 mm thickness
- No knots or splits, maximum stability and mechanical strength thanks to Finger Joint technology
- Non-toxic water-based coating: 3 layers of paint

HANDRAIL

- In plastic material matching the color of the structure

STRUCTURE

- Steel modular elements
- Powder coated with matt scratch proof finish

RAILING

- Steel vertical columns painted in the same color as the structure (distance between the columns less than 10 cm)

Wood colors (steps)

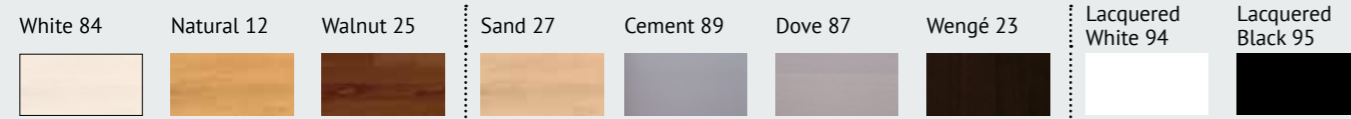

Steel colors (structure and railing)

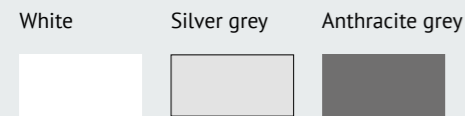

CONFIGURATIONS

SQUARE OPENING

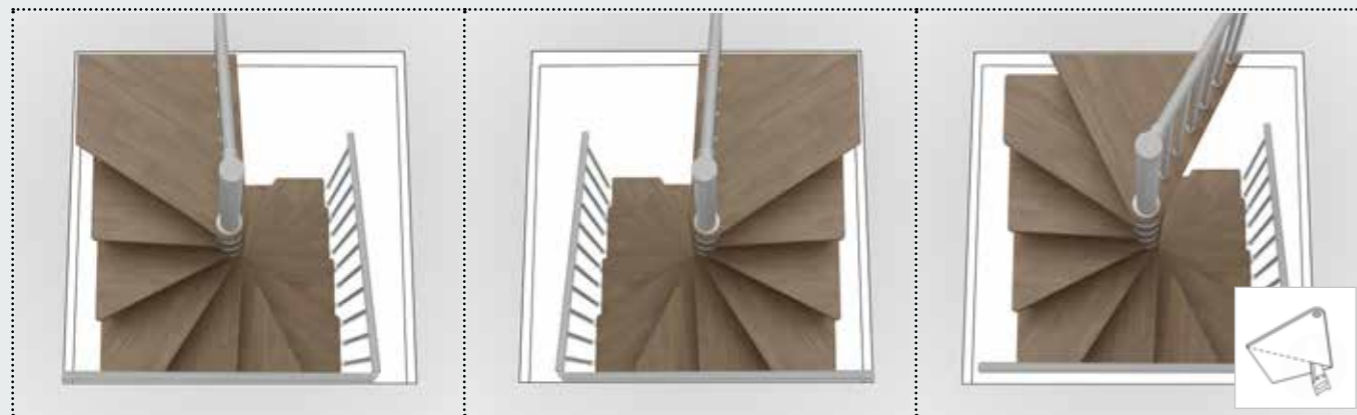

UNIVERSAL LANDING WITH 60° OPENING: adaptable to any opening during installation.

SQUARE BASE SPIRAL STAIRCASE: adapts to corners perfectly.

PACKAGE

1 box = 1 complete staircase of 13 steps (landing included)
Structure, steps, railing (two sides), handrail

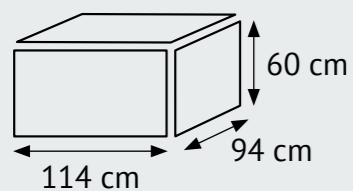

The measures of the box may vary

MEASUREMENTS valid for all the configurations

The **SYSTEM FOR ADJUSTING THE HEIGHT BETWEEN THE STEPS (RISE)** allows you to:

- Obtain different heights between floors with the same number of steps.
- Obtain the height between the floors as required with more or fewer steps (this means you can find the best compromise between the step height and the space occupied by the staircase).

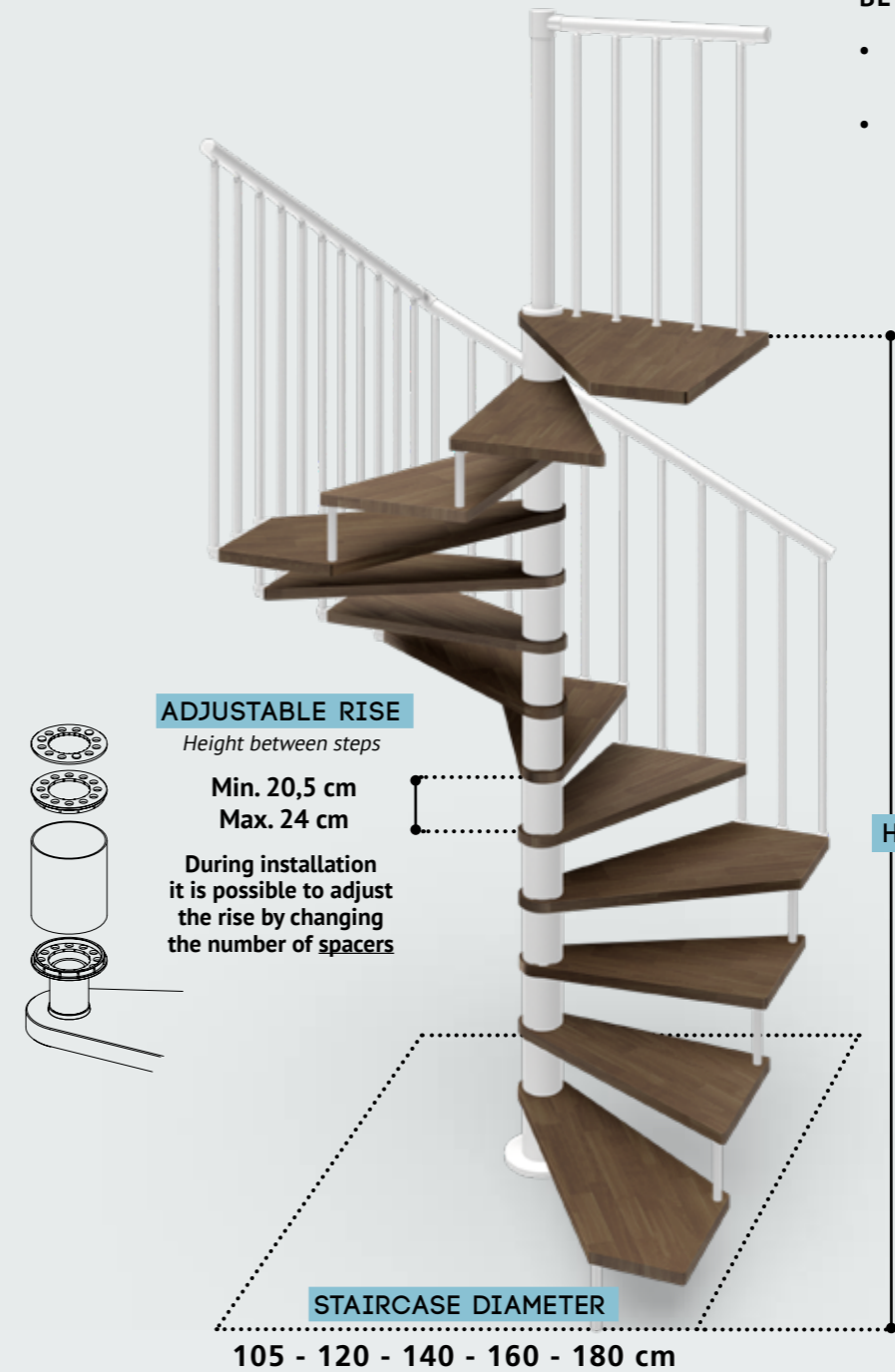

NUMBER OF STEPS	HEIGHT BETWEEN FLOORS (H)
10 steps 1 box	Min. 205 cm Max. 240 cm
11 steps 1 box	Min. 226 cm Max. 264 cm
12 steps 1 box	Min. 246 cm Max. 288 cm
13 steps 1 box	Min. 267 cm Max. 312 cm
14 steps 1 box + 1 extra step	Min. 287 cm Max. 336 cm
15 steps 1 box + 2 extra steps	Min. 308 cm Max. 360 cm
16 steps 1 box + 3 extra steps	Min. 328 cm Max. 384 cm

Add more steps to reach greater heights.

- H = Finished floor to finished floor height.
- Top universal landing fixed at the same level as the finished upper floor.
- Ceiling opening diameter: staircase diameter + 5 cm.

DIRECTION OF ASCENT

Clockwise Counter clockwise

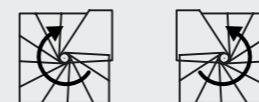

ACCESSORIES

Extra step (with structure).	Railing (one side).	Wooden handrail (one side).	Balustrade for upper floor (100 cm).	Extra section of internal post (needed for heights over 319 cm).